

## Peak Performers

### Replacement Parts for Agilent FID Detectors

By Donna Lidgett, GC Accessories Product Marketing Manager and Sue Benes, GC Accessories Product Marketing Manager



#### FID Replacement Jets

##### Standard Version

- Engineered with a fluted tip to guide the capillary column into the jet.
- Threads specially coated for easy installation and removal.
- Special processing ensures the highest degree of cleanliness.

##### High-Performance Version

- Similar to the standard version, but Siltek® treated.
- Extremely inert, for use with active compounds.

#### Capillary Adaptable FID Replacement Jet for Agilent 5890/6890/6850 GCs

	Similar to Agilent part #	qty.	cat.#	qty.	cat.#
0.011-Inch ID Tip					
Standard, 0.011-Inch ID Tip	19244-80560	ea.	20670	3-pk.	20671
High-Performance Siltek® Treated, 0.011-Inch ID Tip	19244-80560	ea.	20672	3-pk.	20673

#### Capillary Dedicated FID Replacement Jet for Agilent 6890/6850/7890 GCs

	Similar to Agilent part #	qty.	cat.#	qty.	cat.#
0.011-Inch ID Tip					
Standard, 0.011-Inch ID Tip	G1531-80560	ea.	21621	3-pk.	21682
High-Performance Siltek® Treated, 0.011-Inch ID Tip	G1531-80560	ea.	21620	3-pk.	21683

#### Packed Column FID Replacement Jets for Agilent 5890/6890/6850 GCs

	Similar to Agilent part #	qty.	cat.#	qty.	cat.#
0.018-Inch ID Tip*					
Standard, 0.018-Inch ID Tip	18710-20119	ea.	21694	3-pk.	21695
High-Performance Siltek® Treated, 0.018-Inch ID Tip	18710-20119	ea.	21696	3-pk.	21697

	Similar to Agilent part #	qty.	cat.#	qty.	cat.#
0.030-Inch ID Tip*					
Standard, 0.030-Inch ID Tip	18789-80070	ea.	21688	3-pk.	21689
High-Performance Siltek® Treated, 0.030-Inch ID Tip	18789-80070	ea.	21686	3-pk.	21687

\* 0.018-inch ID jets: Used for most general-purpose packed column applications.

\*\* 0.030-inch ID jets: For packings that exhibit high bleed and that frequently clog the tip of smaller 0.018-inch jets.

### tech tip

#### Which FID Jet Should I Use?

There are two FID jet configurations for Agilent GCs. The longer “adaptable” jet fits both 5890 and 6890 GCs, and can be used with capillary or packed columns. The shorter “dedicated” jet is for the FID in the 6890 GC that is designed only for use with capillary columns.

restek  
innovation!

#### FID Jet Removal Tool for Agilent 5890/6890/6850/7890 FIDs

- Securely grips jet in socket for easy removal or installation.
- Unique, ergonomic handle—easy to hold.

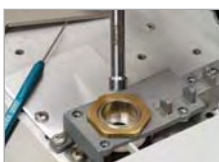

Slip tool  
over FID  
jet...



...loosen  
jet...



...and  
remove.

Description	qty.	cat.#
FID Jet Removal Tool for Agilent 5890/6890/6850/7890 FIDs	ea.	22328

#### FID Gauge Pack for Agilent 5890 GCs

Pressure regulators and gauges for air & hydrogen. The 1/8-inch bulkhead allows easy hookup to instrument. Rated for inlet pressures to 250psi (1724kPa), outlet pressures of 0 to 60psi (0-414kPa).

Description	qty.	cat.#
FID Gauge Pack for Agilent 5890 GCs	ea.	22071



Rugged design!

### Direct Replacement FID Collector Assembly Kit for Agilent 5890 GCs

Description	Similar to Agilent part #	qty.	cat.#
E) FID Collector Assembly Kit (includes insulators)	19231-60690	kit	23010
E) FID Collector Assembly Kit w/Siltek® Ignitor Castle	—	kit	21131

### Replacement FID Parts for Agilent 5890 GCs

Description	Similar to Agilent part #	qty.	cat.#
A) FID Collector (includes insulators)	19231-20970 19231-20960 19231-20950 19231-20940	ea.	21138
B) FID Collector Nut and Washer	5181-3311	set	21136
C) FID Ignitor*	19231-60680	ea.	21001
D) FID Ignitor Castle	19231-20910	ea.	21137
Siltek® FID Ignitor Castle	—	ea.	21135

\*Also fits OI Analytical 4410 detector (similar to OI part # 191833).

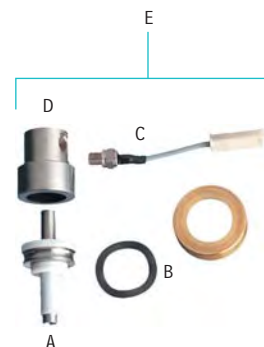

### Direct Replacement FID Collector Assembly Kit for Agilent 6890/6850/7890 GCs

Description	Similar to Agilent part #	qty.	cat.#
5) FID Collector Assembly Kit (includes insulator)	G1531-60690	kit	21699
5) FID Collector Assembly Kit w/Siltek® Ignitor Castle	—	kit	21132

### Replacement FID Parts for Agilent 6890/6850/7890 GCs

Description	Similar to Agilent part #	qty.	cat.#
1) FID Collector (includes insulators)	G1531-20690 G1531-20700 19231-20940	ea.	21139
2) FID Collector Nut and Washer	5181-3311	set	21136
3) FID Ignitor*	19231-60680	ea.	21001
4) FID Ignitor Castle	19231-20910	ea.	21137
Siltek® FID Ignitor Castle	—	ea.	21135

\*Also fits OI Analytical 4410 detector (similar to OI part # 191833).

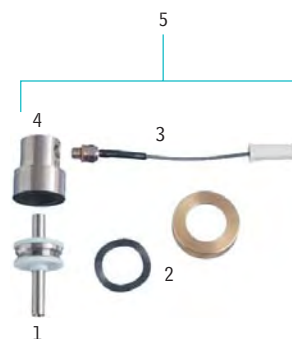

### FID Base Weldment for Agilent GCs

- Meets or exceeds manufacturer's performance.
- Includes brass nut.

Description	Similar to Agilent part #	qty.	cat.#
A) FID Base Weldment for Agilent 5890 GCs	19231-80580	ea.	23041
B) FID Base Weldment, Pack Column FID, for Agilent 6850/6890 GCs	G1531-80580	ea.	23052
C) FID Base Weldment, Capillary Column FID, for Agilent 6850/6890 GCs	G1531-80630	ea.	23053

Note: 6890 GC connections to EPC modules are not compatible with the 7890 EPC modules.



### Spanner Wrench for Agilent 5890/6890/6850/7890 FID Collector Assemblies

- Easily remove the nut from the FID collector without damaging the nut.
- Unique, ergonomic handle—easy to grip.



Remove FID ignitor castle.



Easily loosen the nut by aligning the two pins on the bottom of the wrench with the two open slots on the nut...



...then turn counter-clockwise...



...and remove.



Description	Similar to Agilent part #	qty.	cat.#
Spanner Wrench for Agilent 5890/6890/6850/7890 FID Collector Assembly	19231-00130	ea.	22329