

ECD/FID Make-up Gas Kit for Agilent GCs without Make-up Gas

(Make-up Gas Kit—cat.#21300; ECD/FID Replacement Fitting—cat.# 21324)

Parts List (with replacement part numbers):

1. Replacement make-up gas fitting (cat. # 21324)
2. 1/4-inch stainless steel nut (cat.# 21902)
3. 1/4-inch Vespel®/graphite ferrule (cat.# 20221)
4. 1/16-inch stainless steel nut (cat.# 21900)
5. 0.4mm ID graphite ferrule (cat.# 20200)
6. Siltek®-treated guide (cat.# 21302)*
7. Variable flow restrictor - *not shown*

*included in complete kit (cat.# 21300)

Overview

This kit contains everything needed to add make-up gas to an Agilent 5890 GC with ECD or FID detectors. It is designed to function with an ECD when the Siltek®-treated guide (item 6) is inserted into the hole at the top of the fitting and firmly pressed into place. The column end should terminate close to the outlet of the Siltek®-treated guide. The fitting also can be used with an FID by removing the guide. The tail of the FID jet takes the place of the guide. All column insertion distances remain the same as with the original equipment. Consult your GC operating manual to determine the best make-up gas flow rate for your detector.

Installation Instructions

1. Reduce the detector temperature to less than 50°C.
2. Plumb a 1/8-inch line from the gas source (preferably nitrogen) to the GC, using either copper or instrument-grade stainless steel tubing*. Install the variable flow restrictor (item 7) in a convenient location such as inside the left compartment of the Agilent 5890 GC.
3. Connect the make-up gas source to the variable flow restrictor inlet. Set the source pressure between 30 and 100psig and confirm the flow at the outlet of the restrictor.
4. Remove any existing make-up gas fittings or any inserts from the 1/4-inch detector port.

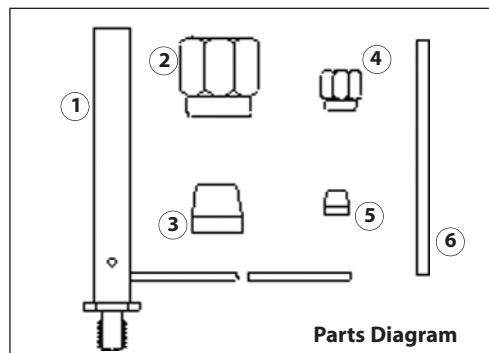

5. Route the 1/16-inch line through an existing oven hole to the variable flow outlet. If no hole exists, drill a hole in a place away from existing lines or electronics. Before pushing the tubing through the insulation, place a plastic cap or a piece of tape over the tubing end.
6. Connect the 1/16-inch line to the variable flow restrictor gas outlet fitting.
7. Insert the Siltek®-treated guide (item 6). (Omit the guide if an FID will be used.) Connect the replacement make-up gas fitting (item 1) to the detector port, using the 1/4-inch nut and ferrule (items 2 & 3) provided.
8. Cap the column connection to the detector and leak-check all connections with a Restek Leak Detector (cat.# 22839). After confirming that all fittings are leak-free, adjust the variable flow restrictor to set the make-up gas flow as indicated in the instrument manual.
9. Install the column, using the 1/16-inch nut and ferrule (items 4 & 5), according to the procedure outlined in your instrument manual and Restek's online column installation guide (www.restek.com/guide_cap.asp).

*To avoid the possibility of contamination, we highly recommend using our instrument-grade stainless steel tubing (cat.# 21512) for plumbing the make-up gas system.

Restek trademarks: Restek logo, Siltek
Other trademarks: Vespel (E.I. du Pont de Nemours & Co., Inc.)

**Call Technical Service at 800-356-1688 or 814-353-1300, ext. 4 (or your Restek representative)
if you have any questions about this product or any other Restek product.**



ISO 9001:2000 #203-02 [007]
cert. # FH03377 Rev: 07/2008

Restek U.S. • 110 Benner Circle • Bellefonte, PA 16823

phone: 814-353-1300 or 800-356-1688 • fax: 814-353-1309 • www.restek.com

Restek France • phone: 33 (0)1 60 78 32 10 • fax: 33 (0)1 60 78 70 90 • e-mail: restek@restekfrance.fr

Restek Ireland • phone: 44 2890 814576 • fax: 44 2890 814576 • e-mail: restekeurope@aol.com

Thames Restek U.K. LTD • phone: 44 1494 563377 • fax: 44 1494 564990 • e-mail: sales@thamesrestek.co.uk

Restek GmbH • phone: +49 (0) 6172 2797 0 • fax: +49 (0) 6172 2797 77 • e-mail: info@restekgmbh.de