

EZ Twist Top™ Split/Splitless Injection Ports

For Agilent 5890 GCs
cat.# 22725, 22726

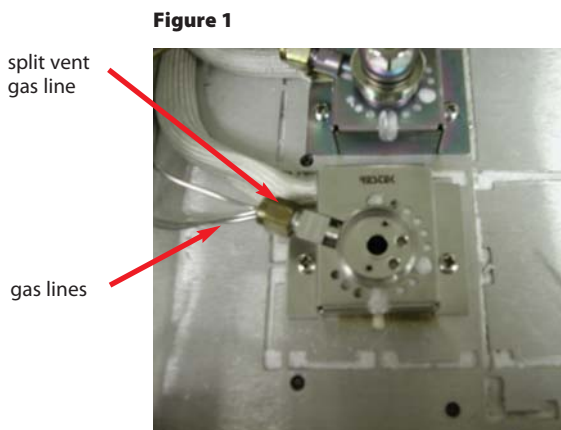
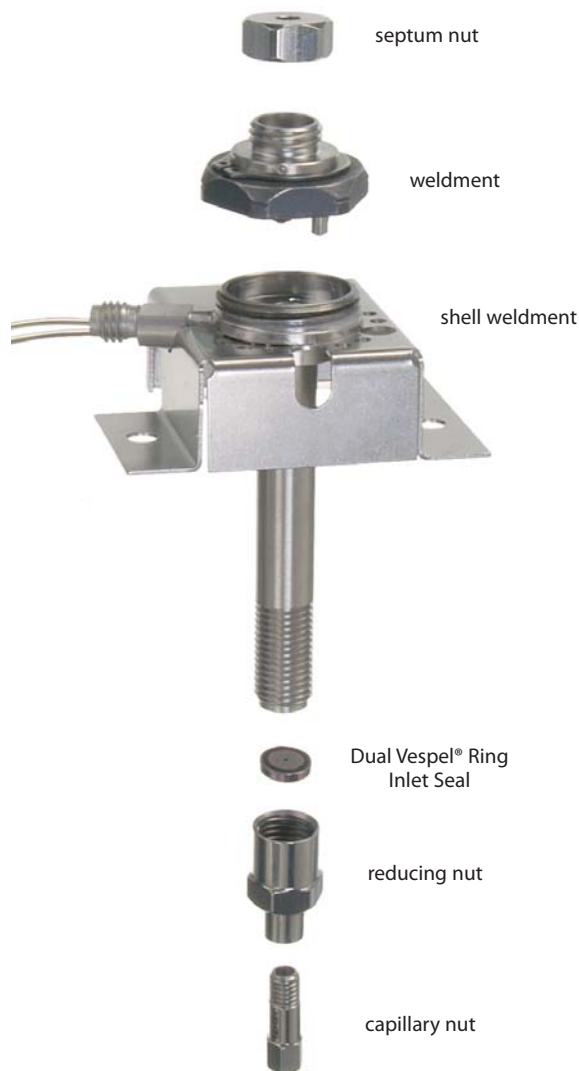

Before Starting:

1. Turn off the main power to the instrument and unplug the power cord from the receptacle. Allow adequate time for the instrument's heated zones to cool.
2. Turn off the main source of carrier gas to the instrument.

Removing the original Agilent injection port:

1. Consult the instrument manufacturer's handbook.

Installing the EZ Twist Top™ injection port:

1. Slide the insulation and the heater block onto the weldment. Screw the thermal nut onto the weldment.
2. Place the shell weldment into the top of the oven. Run the gas lines as shown in Figure 1. Secure with the provided finger-tight nuts and O-rings.
3. Replace the split vent gas line onto the shell weldment. Tighten securely.
4. Place the Dual Vespel® Ring Inlet Seal into the reducing nut and screw onto the shell weldment.

5. Install an inlet sleeve into the shell weldment, using a Viton® O-ring. Make sure the small Viton® O-rings are positioned correctly on the bottom of the weldment (Figure 2). Place the weldment on the top of the shell weldment. Align the pins on the weldment with the holes in the shell weldment. Thread the weldment onto the shell weldment. Tighten, using the Weldment Removal Tool (cat. # 22728) (Figure 3).
6. Place a 11mm septum into the split/splitless weldment. Tighten the septum nut.
7. Install the capillary nut and ferrule onto the column. Install the column.
8. Turn the carrier gas on and check for leaks using Restek's Electronic Leak Detector (cat.# 22839). If an electronic leak detector is not available, perform a pressure decay test. If no leaks are present, replace the side panel and restore power.

Changing the inlet sleeve/liner on the EZ Twist Top™ injection port:

1. Slip the Weldment Removal Tool over the weldment. Push down on the tool to secure the weldment in the socket. Turn counter clockwise to loosen the weldment, then lift straight up. For speed and efficiency, the weldment stays secured in the Weldment Removal Tool.
2. Replace the inlet liner and O-ring in the shell weldment. Examine the two small O-rings on the weldment and change accordingly.
3. Place the weldment onto the top of the shell weldment. Align the pins and slots. Tighten the weldment.
4. Leak check the injection port. If a leak is present, tighten the weldment 1/4 turn at a time, leak checking after each 1/4 turn.

SILTEK
Treatment Available
for **Maximum** Inertness

EZ Twist Top™ Split/Splitless Injection Port for Agilent 5890 GCs

Description	qty.	cat.#
Complete injection port assembly kit includes: split/splitless weldment, shell weldment, 2 weldment O-rings, Siltek Dual Vespel Ring inlet seal, septum nut, reducing nut, stainless steel capillary nut and weldment tool	kit	22725
Siltek complete injection port assembly kit includes: Siltek split/splitless weldment, Siltek shell weldment, 2 weldment O-rings, Siltek Dual Vespel Ring inlet seal, septum nut, reducing nut, stainless steel capillary nut and weldment tool	kit	22726
Split/Splitless Weldment for Agilent 5890/6890/6850 GCs (2 weldment O-rings are installed on the weldment)	ea.	22724
Siltek Split/Splitless Weldment for Agilent 5890/6890/6850 GCs (2 weldment O-rings are installed on the weldment)	ea.	22732
Shell Weldment for Agilent 5890 GCs	ea.	22727
Siltek Shell Weldment for Agilent 5890 GCs	ea.	22731
Weldment O-rings	10-pk.	22729
Autosampler & PTV Septum Nut (for 23-gauge needles)	ea.	20631
Reducing Nut	2-pk.	20883
Reducing Nut	ea.	22078
Siltek 0.8mm ID Dual Vespel Ring Inlet Seal	2-pk.	21242
Siltek 0.8mm ID Dual Vespel Ring Inlet Seal	10-pk.	21243
Weldment Removal Tool for Agilent 5890/6890/6850 GCs	ea.	22728



Weldment Removal Tool

Restek trademarks: EZ Twist Top, Restek logo, Siltek
Other trademarks: Vespel, Viton (E.I. du Pont de Nemours & Co., Inc.)

Call Technical Service at 800-356-1688, ext. 4 or 814-353-1300, ext. 4 (or contact your Restek representative) if you have any questions about this product or any other Restek product.



ISO 9001:2000
cert. # FMS0302
#203-02 [029]
Rev. date: 07/2008

Restek U.S. • 110 Benner Circle • Bellefonte, PA 16823
phone: 814-353-1300 or 800-356-1688 • fax: 814-353-1309 • www.restek.com
Restek France • phone: 33 (0)1 60 78 32 10 • fax: 33 (0)1 60 78 70 90 • e-mail: restek@restekfrance.fr
Restek Ireland • phone: 44 2890 814576 • fax: 44 2890 814576 • e-mail: restekurope@aol.com
Thames Restek U.K. LTD • phone: 44 1494 563377 • fax: 44 1494 564990 • e-mail: sales@thamesrestek.co.uk
Restek GmbH • phone: +49 (0) 6172 2797 0 • fax: +49 (0) 6172 2797 77 • e-mail: info@restekgmbh.de