

Sure Fit Split/Splitless Injection Ports

For Agilent 5890 GCs

- cat.# 22323 uses Restek Enhanced Base Fitting
- cat.# 22326 uses Manufacturer's-Style Reducing Nut and Inlet Seal

Uses Restek Enhanced Base Fitting Cat.# 22323

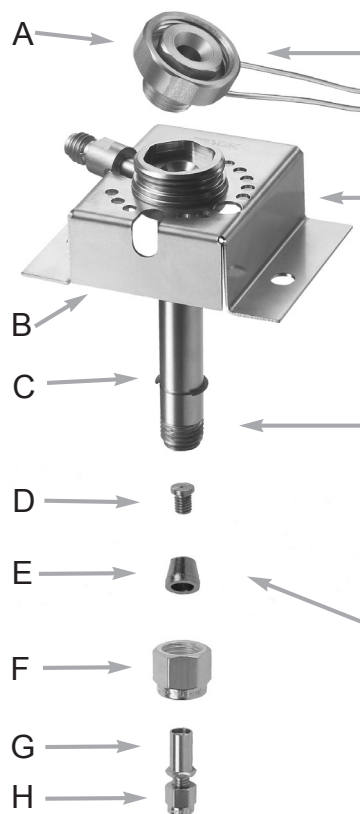

Hex design aligns every time for easy installation and removal.

Leak-tight injection port remains sealed at temperatures as high as 400°C.

Redesigned injector base improves seal and simplifies column installation.

Standard 1/4" ferrule.

Uses Manufacturer's-Style Reducing Nut and Inlet Seal Cat.# 22326

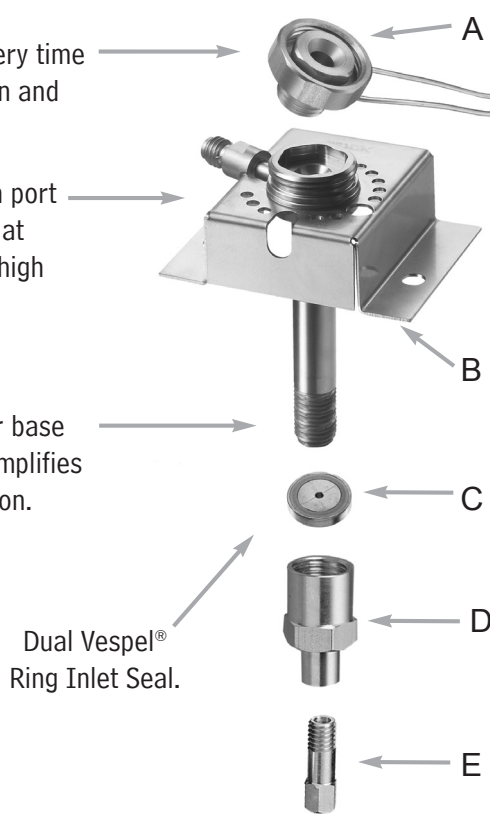

Dual Vespel® Ring Inlet Seal.

- A. split/splitless weldment
- B. shell weldment
- C. snap ring
- D. base screw
- E. 1/4" ferrule
- F. 1/4" nut
- G. base fitting
- H. 1/16" nut

- A. split/splitless weldment
- B. shell weldment
- C. inlet seal
- D. reducing nut
- E. capillary nut

Before Starting:

1. Turn off the main power to the instrument and unplug the power cord from the receptacle. Allow adequate time for the instrument's heated zones to cool.
2. Turn off the main source of carrier gas to the instrument.

Removing the Agilent original injection port:

Consult instrument manufacturer handbook.

Installing the Restek Sure Fit injection port:

1. Place the insulation from the Agilent original shell weldment into the Restek shell weldment.
2. Carefully insert the heater block onto the Restek shell weldment. Place the snap ring onto the shell weldment.
3. Place the shell weldment into the top of the oven and secure with the original screws.
4. Replace the split vent gas line onto the shell weldment and tighten securely.

5. Snap the two plastic finger-tight nuts onto the carrier and purge lines along with the O-rings. Reattach the carrier gas line (labeled "C" on the weldment) to the chemical trap. Reattach the septum purge to the three-way solenoid valve (labeled "P" on the weldment). Route the tubing along its original position.
- 6a. For Sure Fit Enhanced Base Fitting injection port: assemble the base fitting and screw onto the weldment.
- 6b. For Manufacturer's-Style Reducing Nut: place the Dual Vespel® Ring inlet seal into the reducing nut and screw onto the shell weldment.
7. Install the inlet liner into the top of the injection port. Place the ferrule over the inlet liner (6.3mm ID for a split liner or 6.5mm ID for a splitless liner). Tighten the split/splitless weldment onto the shell weldment.
8. Place a 10 or 11mm septum into the split/splitless weldment and tighten.
9. Seal the end of the injector base fitting with the 1/16-inch nut and a no-hole ferrule. Turn the carrier gas on and check for leaks using the Restek Electronic Leak Detector (cat.# 22839). If an electronic leak detector is not available, perform a pressure decay test.
10. If no leaks are present, replace the side panel and restore power.
- 11a. For Sure Fit Enhanced Base Fitting: install 36-38mm from the back of the nut.
- 11b. For Manufacturer's-Style Reducing Nut: install 27-31mm from the back of the nut.

Sure Fit Split/Splitless Injection Ports for Agilent 5890 GCs by Restek

Uses Restek Enhanced Base Fitting

Description	qty.	cat.#
Injection Port Assembly Kit includes:* Siltek split/splitless weldment, Siltek shell weldment, base fitting, Siltek base screw, septum nut, 1/16" and 1/4" stainless steel nuts, 1/4" graphite ferrule	kit	22323
Siltek Split/Splitless Weldment for Restek 5890 Injection Port	ea.	22324
Siltek Shell Weldment for Restek 5890 Injection Port	ea.	22325
Siltek Base Screws for Restek Injection Port for 5890/6890	10-pk. 50-pk.	21631 21632
Gold-Plated Base Screws for Restek 5890 Injection Port	2-pk. 10-pk.	21629 21630
Autosampler & PTV Septum Nut (for 23-gauge needles)	ea.	20631
Base Fitting for Restek 5890 Injection Port	ea.	21626

Uses Manufacturer's-Style Reducing Nut and Inlet Seal

Description	qty.	cat.#
Injection Port Assembly Kit includes:* Siltek split/splitless weldment, Siltek shell weldment, septum nut, Siltek Dual Vespel Ring Inlet Seal, Agilent-style stainless steel reducing nut, Agilent-style stainless steel capillary nut	kit	22326
Siltek Split/Splitless Weldment for Restek 5890 Injection Port	ea.	22324
Siltek Split/Splitless Shell Weldment for Restek Injection Port for 5890/6890 (uses standard Agilent inlet seals)	ea.	22327
Autosampler & PTV Septum Nut (for 23-gauge needles)	ea.	20631
Reducing Nut	ea.	22078
Stainless Steel Capillary Column Nut	2-pk.	21884
Siltek 0.8mm ID Dual Vespel Ring Inlet Seal	2-pk. 10-pk.	21242 21243

Ferrules for Split or Splitless Inlet Liners

Description	qty.	cat.#
Ferrules for split liners (6.3mm OD): 1/4" dual-taper Vespel/graphite	10-pk.	20290
Ferrules for splitless liners (6.5mm OD): 1/4" dual-taper Vespel/graphite	10-pk.	20291

*Injection port assembly kit does not include inlet liner, 1/16" capillary ferrule, or split/splitless liner ferrules. Order separately.

Restek trademarks: Restek logo, Siltek.

Other trademarks: Vespel (E.I. du Pont de Nemours & Co., Inc.)

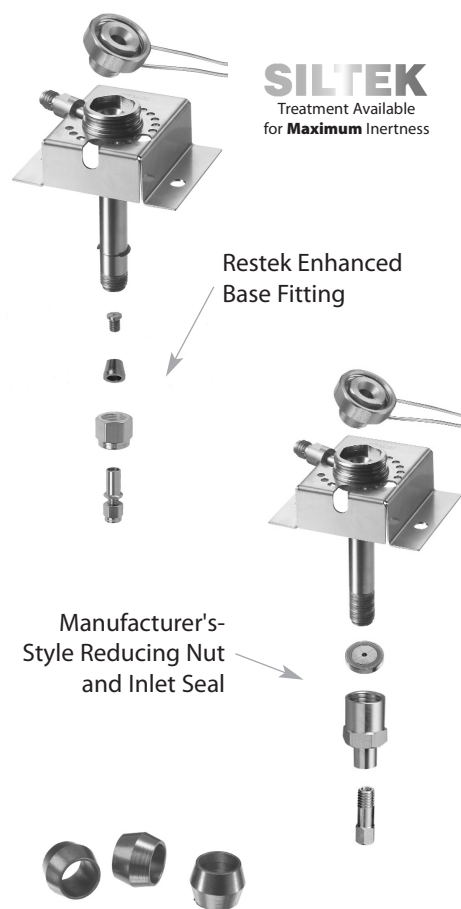

Special dual-taper, 1/4" ID Vespel®/graphite ferrules fit over split liners (6.3mm OD) (cat.# 20290). Slightly larger ferrule ID required for splitless liners (6.5mm OD) (cat.# 20291).

Call Technical Service at 800-356-1688 or 814-353-1300, ext. 4 (or your Restek representative) if you have any questions about this product or any other Restek product.